

# HydroWhirl® Mini



PVDF Reactionary Force



## DESIGN FEATURES

- Fluid-driven, self-flushing
- Compact design, maintenance-free
- Made from FDA-compliant, PVDF material
- Corrosion-resistant
- Hydrostatic wear free slide bearing

## SPRAY CHARACTERISTICS

- Vigorous spray action

**Spray Angles:** Complete 360° spray coverage.

**Flow Rates:** 10.9 to 33.5 L/min

**Max Temperature:** 194° F / 90°C

**Filtration:** Line strainer with a mesh size of 0.3mm/50 mesh

For additional connection types contact BETE.

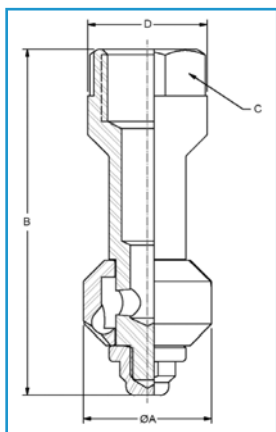

## DIMENSIONS IN MILLIMETERS

Connection Size	A	B	C	Weight (grams)
1/2"	30.5	81.3	22.9	31.1

## HYDROWHIRL® MINI FLOW RATES

Materials: PVDF

Female Connection Type	Nozzle Number	Spray Angles	Flow Rate (L/min) @ Differential Pressure (bar)						Coverage Dia. @ 3 bar
			0.5	0.7	1	2	3	4	
			bar	bar	bar	bar	bar	bar	
1/2" NPT	HWM 7.2	360°	10.9	13.0	15.8	23.0	28.7	33.5	2.0

\*Flow rates represent threaded connections with a 360° spray angle.

\*Flow rates may vary for other connection types and spray angles.

