

M-200TS Recessed Wall Box

Strahman's recessed mixing units are designed to conceal mixing unit piping in a stainless steel box for recessed wall mounting. All exposed parts are either bronze chrome-plated or stainless steel depending on the selected unit. These units are ideal for new construction or other places where concealed piping and good looks are desirable.

The Thermostatically Controlled Hot and Cold Water Mixing Unit features high quality and rugged construction. The unit's accurate, solid, liquid-filled thermostat allows you to set the exact output of water temperature desired from cold to 160°F. Featuring durable bronze body construction with replaceable corrosion-resistant components, the **M-200TS** valve maximizes cleaning effectiveness for any application. Both the piston and liner are made of stainless steel for long-lasting reliability.

Specifications

- ♦ Integral one button shut-off: Pull on and push off
- ♦ Precise temperature control from cold to 110°F to 160°F in this instance (There is a 50° difference from maximum temperature to cool water.)
- ♦ Adjustable temperature limit stop for operator safety
- ♦ Replaceable components facilitate service
- ♦ Optional compressed air outlet

NOTE: 1-year warranty

Please see reverse side for parts listing.



Shown: Recessed Series with **M-200TS** unit;
shown with premium hose assembly and **S-70 Series** nozzle



SprayNozzle ENGINEERING
Total Spraying Solutions

AUSTRALIA – MELBOURNE

Phone: +61 (3) 9583 2368
Mobile: 1800 NOZZLE
Email: sales@spraynozzle.com.au

NEW ZEALAND – PACIFIC RIM

Phone: +64 (7) 839 6444
Mobile: 0800 NOZZLE
Email: sales@spraynozzle.co.nz

M-200TS Recessed Wall Box

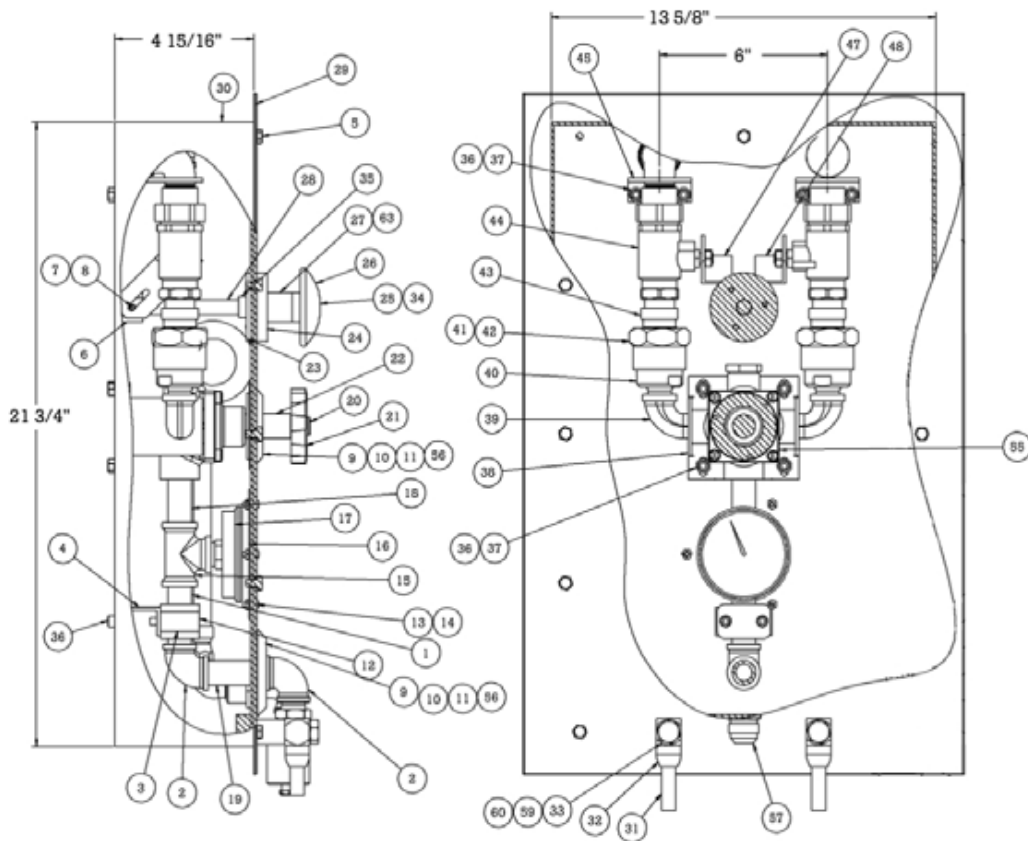

PARTS

PART NO.	DESCRIPTION	PART NO.	DESCRIPTION	PART NO.	DESCRIPTION
1	½ NIPPLE 3 BRASS	19	½ X 3" LONG NIPPLE SST	37	¼ WASHER
2	½ ELBOW BRASS	20	5/16-24 X 2" FLAT HEAD SST	38	VALVE BRACKET
3	½" PIPE SUPPORT	21	CONTROL KNOB	39	½ STREET ELBOW BRASS
4	PIPE SUPPORT SPACER	22	CONTROL EXTENSION	40	ADAPTER
5	¼-20 X 3/8 BOLT SST	23	STEM SLEEVE RETAINER	41	BALL CHECK NUT
6	STEM NUCKEL	24	10-32 X ¾ FLAT HEAD	42	BALL CHECK GASKET
7	CLEVIS PIN	25	¼-20 X ¾ FLAT HEAD	43	BALL CHECK
8	NO. 10 WASHERS	26	PALM KNOB	44	BALL VALVE
9	ESCUTCHON PLATE	27	STEM SLEEVE	45	BRACKET
10	8-32 X 3/16 PAN HD SCR	28	STEM ROD	47	LINKAGE ARM LEFT
11	CLIP	29	COVER	48	LINKAGE ARM RIGHT
12	¼-20 X 1 ¾ LONG SHCS	30	BOX	55	MIXING VALVE
13	8-32 X 3/8 PAN HEAD SST	31	HOSE RACK	56	3/8 HOSE BARB
14	8-32 X NUT SST	32	HOSE RACK CONNECTOR	57	UNIT END ADAPTER
15	½ TEE BRASS	33	½-13 X ½ LONG BOLT	58	COTTER PIN
16	LENZ	34	FINISH WASHER	59	HOSE RACK SPACER
17	TEMPERATURE GAUGE	35	BUMPER	60	½ STAR WASHER
18	½ X 2½" NIPPLE BRASS	36	¼-20 X ½ SHCS SST	63	BRONZE BEARING



SprayNozzleENGINEERING
Total Spraying Solutions

AUSTRALIA – MELBOURNE
Phone: +61 (3) 9583 2368
Mobile: 1800 NOZZLE
Email: sales@spraynozzle.com.au

NEW ZEALAND – PACIFIC RIM
Phone: +64 (7) 839 6444
Mobile: 0800 NOZZLE
Email: sales@spraynozzle.co.nz

M-200TS Thermostatically Controlled Mixing Unit

The Model **M-200TS** features rugged construction and superb quality for superior thermostatic control. The unit's accurate and solid, liquid-filled thermostat allows you to set the exact output water temperature desired — from 80°F to 160°F. With its durable bronze body construction, the **M-200TS** valve features replaceable components that resist corrosion. Both the piston and liner are made of stainless steel material for long-lasting reliability. The unit also includes an integral shut-off valve. Backed by a one year warranty.

Specifications

- ♦ Maximum water temperature 160°F/71°C
- ♦ Maximum working pressure 125 psi
- ♦ Maintains temperature to +/-3°F
- ♦ ½" low flow unit 5-7 gpm
- ♦ ¾" high flow unit 10-12 gpm
- ♦ Single lever On/Off operation
- ♦ Precise temperature control from 80°F/27°C to 160°F/71°C
- ♦ Adjustable temperature limit stop for maximum safety
- ♦ Replaceable components facilitate servicing
- ♦ Senses and compensates for temperature or pressure fluctuations (up to a 50% drop in inlet supply pressure)

Please see reverse side for parts listing.

Foreign deposits in supply lines can affect ball check durability.



Shown: Bronze **M-200TS** unit; shown with premium hose assembly and **M-70 Series** nozzle.
Unit also available in chrome-plated.

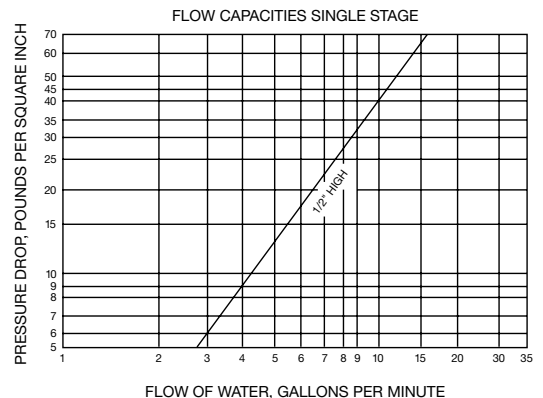

SprayNozzle ENGINEERING
Total Spraying Solutions

AUSTRALIA – MELBOURNE

Phone: +61 (3) 9583 2368
Mobile: 1800 NOZZLE
Email: sales@spraynozzle.com.au

NEW ZEALAND – PACIFIC RIM

Phone: +64 (7) 839 6444
Mobile: 0800 NOZZLE
Email: sales@spraynozzle.co.nz